

Telephone: 598 26040329
ext. 1260, 1463
Telefax: 598 26040067
AFTN: SUMUYNYX
e-mail: ais@adinet.com.uy

URUGUAY

Dirección Nacional de Aviación Civil e Infraestructura Aeronáutica
Servicio de Información Aeronáutica
Aeropuerto Intl de Carrasco "Gral. Cesáreo L. Berisso"
14000 Canelones

AIRAC AIP
AMDT
NR 08
26 DEC 2024

The entries with an indicator (☛) at the margin indicates changes in the paragraph

EFFECTIVE DATE: 20 FEB 2025 - 00:01 UTC

THIS AMDT MUST NOT BE INSERTED INTO THE AIP BEFORE THE EFFECTIVE DATE. HOWEVER, IT IS SUGGESTED TO STUDY ITS CONTENT BEFORE THAT DATE.

INSERT AND/OR DESTROY THE FOLLOWING PAGES:

DESTROY		INSERT	
GEN		GEN	
0.4-1.....	28 NOV 2024	0.4-1.....	20 FEB 2025
0.4-2.....	03 OCT 2024	0.4-2.....	20 FEB 2025
0.4-3.....	03 OCT 2024	0.4-3.....	03 OCT 2024
0.4-4.....	03 OCT 2024	0.4-4.....	20 FEB 2025
3.2-5.....	28 NOV 2024	3.2-5.....	20 FEB 2025
3.2-6.....	28 NOV 2024	3.2-6.....	28 NOV 2024
3.3-3.....	08 SEP 2022	3.3-3.....	20 FEB 2025
3.7-1.....	01 DEC 2014	3.7-1.....	20 FEB 2025
3.7-2.....	01 DEC 2014	3.7-2.....	01 DEC 2014
AD		AD	
2.4-1.....	27 JAN 2022	2.4-1.....	20 FEB 2025
2.4-2.....	10 DEC 2015	2.4-2.....	20 FEB 2025
2.4-3.....	02 JAN 2017	2.4-3.....	20 FEB 2025
2.4-4.....	01 DEC 2007	2.4-4.....	01 DEC 2007
2.4-13.....	13 JUN 2024	2.4-13.....	20 FEB 2025
2.4-15.....	13 JUN 2024	2.4-15.....	20 FEB 2025

AIRAC AIP/SUP included in this AMDT:

Nil.

AIC included in this AMDT:

Nil.

AIP Supplements included in this AMDT:
Nil.

NOTAM included in this AMDT:
Nil.

**Remember to record the inclusion of the amendment on page GEN 0.2-1
Record of AIP Amendments**

→→→→→→→→→→

GEN 0.4 CHECKLIST OF AIP PAGES

<i>Page</i>	<i>Date</i>	<i>Page</i>	<i>Date</i>	<i>Page</i>	<i>Date</i>
PART 1 GENERAL (GEN)		GEN 2		GEN 3	
0.1-1	21 APR 2022	2.1-1	07 SEP 2023	3.1-1	11 JUL 2024
0.1-2	21 APR 2022	2.1-2	07 SEP 2023	3.1-2	07 SEP 2023
0.1-3	05 OCT 2023	2.1-3	07 SEP 2023	3.1-3	07 SEP 2023
0.1-4	27 JAN 2022	2.2-1	02 JAN 2017	3.1-4	23 MAR 2023
0.2-1	13 JUN 2024	2.2-2	02 JAN 2017	3.1-5	02 JAN 2017
0.3-1	01 JUN 1997	2.2-3	02 JAN 2017	3.1-6	07 SEP 2023
☛0.4-1	20 FEB 2025	2.2-4	12 AUG 2021	3.1-7	11 JUL 2024
☛0.4-2	20 FEB 2025	2.2-5	02 JAN 2017	3.1-8	07 SEP 2023
0.4-3	03 OCT 2024	2.2-6	03 OCT 2024	3.2-1	11 JUL 2024
☛0.4-4	20 FEB 2025	2.2-7	28 MAR 2019	3.2-2	25 JAN 2024
0.4-5	28 NOV 2024	2.2-8	02 JAN 2017	3.2-3	18 JUL 2019
0.4-6	03 OCT 2024	2.2-9	02 JAN 2017	3.2-4	25 JAN 2024
0.5-1	01 JUN 1997	2.2-10	02 JAN 2017	☛3.2-5	20 FEB 2025
0.6-1	01 JUN 1997	2.2-11	02 JAN 2017	☛3.2-6	20 FEB 2025
0.6-2	01 DEC 2006	2.2-12	02 JAN 2017	3.2-7	05 SEP 2024
0.6-3	01 APR 2005	2.2-13	02 JAN 2017	3.2-8	11 JUL 2024
		2.2-14	02 JAN 2017	3.3-1	08 SEP 2022
		2.2-15	02 JAN 2017	3.3-2	06 OCT 2022
GEN 1		2.3-1	01 DEC 2005	☛3.3-3	20 FEB 2025
1.1-1	05 DEC 2019	2.3-2	01 DEC 2005	3.4-1	01 DEC 2010
1.1-2	12 AUG 2021	2.3-3	01 DEC 2005	3.4-2	01 DEC 2001
1.1-3	01 DEC 2010	2.3-4	01 DEC 2005	3.4-3	01 AUG 2002
1.2-1	21 APR 2022	2.3-5	01 APR 2017	3.4-4	01 DEC 2009
1.2-2	21 APR 2022	2.3-6	05 NOV 2020	3.4-5	01 DEC 2009
1.2-3	21 APR 2022	2.3-7	03 OCT 2024	3.4-6	01 DEC 2002
1.2-4	20 MAY 2021	2.3-8	01 AUG 2011	3.5-1	03 NOV 2022
1.2-5	20 MAY 2021	2.4-1	01 JUN 2008	3.5-2	05 DEC 2019
1.2-6	20 MAY 2021	2.4-2	01 AUG 2010	3.5-3	06 OCT 2022
1.2-7	04 NOV 2021	2.4-3	01 DEC 2004	3.5-4	06 OCT 2022
1.3-1	01 AUG 2016	2.4-4	01 DEC 2002	3.5-5	05 DEC 2019
1.3-2	01 DEC 2001	2.4-5	01 DEC 2002	3.5-6	05 DEC 2019
1.4-1	21 APR 2022	2.5-1	21 MAR 2024	3.5-7	05 DEC 2019
1.4-2	21 APR 2022	2.5-2	01 AUG 2010	3.5-8	05 DEC 2019
1.4-3	21 APR 2022	2.5-3	01 AUG 2010	3.5-9	05 DEC 2019
1.5-1	01 DEC 2018	2.6-1	01 JUN 1997	3.5-10	05 DEC 2019
1.6-1	03 NOV 2022	2.6-2	01 JUN 1997	3.6-1	01 APR 2011
1.7-1	05 SEP 2024	2.7-1	18 APR 2024	3.6-2	01 DEC 2008
1.7-2	18 JUL 2019	2.7-2	18 APR 2024	3.6-3	01 DEC 2008
1.7-3	23 MAY 2019	2.7-3	18 APR 2024	3.6-4	01 APR 2001
1.7-4	23 MAY 2019	2.7-4	18 APR 2024	3.6-5	01 DEC 2008
		2.7-5	18 APR 2024	3.6-6	12 AUG 2021

<i>Page</i>	<i>Date</i>	<i>Page</i>	<i>Date</i>	<i>Page</i>	<i>Date</i>
3.6-7	18 JUL 2019	1.2-3	11 AUG 2022	1.15-10	03 NOV 2022
3.6-8	18 JUL 2019	1.3-1	25 JAN 2024	1.15-11	03 NOV 2022
3.6-9	28 MAY 2015	1.4-1	01 AUG 2003	1.15-12	03 NOV 2022
3.6-11	01 DEC 2008	1.4-2	05 SEP 2024	1.15-13	03 NOV 2022
☛3.7-1	20 FEB 2025	1.4-3	04 NOV 2021	1.15-14	05 OCT 2023
3.7-2	01 DEC 2014	1.5-1	01 AUG 2016	1.15-15	03 NOV 2022
		1.5-2	01 DEC 2004	1.15-16	03 NOV 2022
GEN 4		1.6-1	21 APR 2022	1.15-17	03 NOV 2022
		1.6-2	28 JAN 2021	1.15-18	05 OCT 2023
4.1-1	01 APR 2006	1.6-3	01 AUG 2009	1.15-19	03 NOV 2022
4.1-2	01 DEC 2004	1.6-4	21 APR 2022	1.15-20	05 OCT 2023
4.1-3	01 DEC 2004	1.7-1	01 AUG 2005	1.16-1	03 NOV 2022
4.1-4	02 JAN 2017	1.7-2	01 DEC 2010	1.17-1	03 NOV 2022
4.1-5	02 JAN 2017	1.7-3	01 APR 2002	1.17-2	03 NOV 2022
4.1-6	02 JAN 2017	1.7-4	01 APR 2002	1.17-3	03 NOV 2022
4.1-7	02 JAN 2017	1.7-5	01 AUG 2005	1.17-4	03 NOV 2022
4.1-8	02 JAN 2017	1.8-1	05 DEC 2019	1.17-5	03 NOV 2022
4.1-9	02 JAN 2017	1.9-1	01 AUG 2005	1.17-6	03 NOV 2022
4.1-10	02 JAN 2017	1.10-1	05 OCT 2023	1.17-7	03 NOV 2022
4.1-11	02 JAN 2017	1.10-2	05 OCT 2023	1.17-8	03 NOV 2022
4.1-12	02 JAN 2017	1.10-3	05 OCT 2023	1.17-9	03 NOV 2022
4.1-13	02 JAN 2017	1.10-4	05 OCT 2023	1.17-10	03 NOV 2022
4.1-14	02 JAN 2017	1.10-5	05 OCT 2023	1.17-11	03 NOV 2022
4.1-15	02 JAN 2017	1.10-6	05 OCT 2023		
4.1-16	02 JAN 2017	1.11-1	01 AUG 2007	ENR 2	
4.1-17	03 OCT 2024	1.12-1	01 JUN 1997		
4.1-18	03 OCT 2024	1.12-2	01 JUN 1997	2.1-1	01 APR 2009
4.1-19	03 OCT 2024	1.12-3	01 JUN 1997	2.1-2	01 DEC 2013
4.1-20	03 OCT 2024	1.12-4	01 JUN 1997	2.1-3	01 DEC 2012
4.1-21	03 OCT 2024	1.13-1	01 JUN 1997	2.1-4	26 MAR 2020
4.1-22	03 OCT 2024	1.14-1	01 JUN 1997	2.1-5	05 NOV 2020
		1.14-2	08 SEP 2022	2.1-7	03 OCT 2024
		1.14-3	01 JUN 1997	2.2-1	05 SEP 2024
		1.14-4	01 DEC 2005	2.2-2	03 OCT 2024
PART 2		1.14-5	01 DEC 2005	2.2-3	05 OCT 2023
EN - ROUTE (ENR)		1.14-6	01 DEC 2005	2.2-4	25 JAN 2024
0.6-1	03 NOV 2022	1.14-7	01 DEC 2005	2.2-5	03 OCT 2024
0.6-2	04 NOV 2021	1.15-1	03 NOV 2022	2.2-6	30 NOV 2023
		1.15-2	03 NOV 2022	2.2-7	05 OCT 2023
ENR 1		1.15-3	03 NOV 2022		
		1.15-4	03 NOV 2022	ENR 3	
1.1-1	23 MAR 2023	1.15-5	03 NOV 2022		
1.1-2	25 JAN 2024	1.15-6	03 NOV 2022	3.1-1	04 NOV 2021
1.1-3	28 MAR 2019	1.15-7	03 NOV 2022	3.1-2	04 NOV 2021
1.2-1	05 SEP 2024	1.15-8	03 NOV 2022	3.1-3	03 OCT 2024
1.2-2	11 AUG 2022	1.15-9	03 NOV 2022		

<i>Page</i>	<i>Date</i>	<i>Page</i>	<i>Date</i>	<i>Page</i>	<i>Date</i>
3.1-4	05 OCT 2023	4.2-4	01 AUG 2003	6.2-3	05 OCT 2023
3.1-5	04 NOV 2021	4.2-5	01 AUG 2010	6.2-5	18 APR 2024
3.1-6	04 NOV 2021	4.2-6	01 AUG 2003	6.3	18 APR 2024
3.1-7	04 NOV 2021	4.2-7	01 APR 2012	6.4	05 OCT 2023
3.1-8	05 OCT 2023	4.3-1	06 OCT 2022	6.5	01 JUN 1997
3.1-9	05 OCT 2023	☛4.3-2	03 OCT 2024	6.6	05 SEP 2024
3.1-10	05 OCT 2023	4.3-3	06 OCT 2022	6.7	21 MAR 2024
3.1-11	04 NOV 2021	4.3-4	05 OCT 2023	6.8	02 JAN 2017
3.1-12	05 OCT 2023	4.3-5	06 OCT 2022	6.9	02 JAN 2017
3.1-13	05 OCT 2023	4.3-6	05 OCT 2023		
3.1-14	05 OCT 2023	☛4.3-7	03 OCT 2024	PART 3	
3.1-15	04 NOV 2021	4.4-1	01 AUG 2014	AERODROMES (AD)	
3.1-16	04 NOV 2021	4.4-2	01 DEC 2014		
3.2-1	04 NOV 2021			0.6-1	01 APR 2012
☛3.2-2	03 OCT 2024	ENR 5		0.6-2	01 APR 2012
3.2-3	04 NOV 2021			0.6-3	01 APR 2012
3.2-4	04 NOV 2021	5.1-1	11 AUG 2022	0.6-4	01 DEC 2004
3.2-5	04 NOV 2021	5.1-2	18 APR 2024	0.6-5	01 DEC 2008
3.2-6	04 NOV 2021	5.1-3	21 APR 2022	0.6-6	01 AUG 2007
3.2-7	04 NOV 2021	5.1-4	21 APR 2022	0.6-7	01 APR 2012
3.2-8	04 NOV 2021	5.1-5	21 APR 2022	0.6-8	01 DEC 2004
3.2-9	04 NOV 2021	5.2-1	11 AUG 2022	0.6-9	01 DEC 2004
3.2-10	04 NOV 2021	5.2-2	05 OCT 2023	0.6-10	02 JAN 2017
3.2-11	04 NOV 2021	5.2-3	05 SEP 2024	0.6-11	02 JAN 2017
3.2-12	05 OCT 2023	5.3-1	05 DEC 2019		
☛3.2-13	04 NOV 2021	5.4-1	01 JUN 1997	AD 1	
3.2-14	05 OCT 2023	5.5-1	05 DEC 2019		
3.2-15	04 NOV 2021	5.5-2	28 JAN 2021	1.1-1	01 DEC 2012
3.2-16	04 NOV 2021	5.5-3	05 SEP 2024	1.1-2	01 DEC 2002
3.2-17	14 JUL 2022	5.5-4	05 SEP 2024	1.1-3	01 AUG 2009
3.2-18	04 NOV 2021	5.5-5	05 SEP 2024	1.1-4	01 DEC 2005
3.2-19	04 NOV 2021	5.6-1	01 DEC 2018	1.1-5	01 DEC 2005
3.3-1	04 NOV 2021	5.6-2	01 MAR 1999	1.2-1	01 JUN 1997
3.3-2	04 NOV 2021	5.6-3	01 AUG 1998	1.3-1	05 OCT 2023
3.3-3	04 NOV 2021			1.3-2	30 NOV 2023
3.3-4	04 NOV 2021	ENR 6		1.3-3	01 APR 2018
3.3-5	04 NOV 2021			1.3-5	05 NOV 2020
3.3-6	04 NOV 2021	☛6.1-1	03 OCT 2024	1.4-1	05 NOV 2020
3.4-1	04 NOV 2021	☛6.1-2	03 OCT 2024	1.5-1	30 NOV 2023
		☛6.1-3	03 OCT 2024	1.5-2	02 JAN 2017
ENR 4		6.1-4	18 APR 2024		
		6.1-5	18 APR 2024	AD 2	
4.1-1	21 MAR 2024	6.1-6	21 MAR 2024		
4.2-1	18 APR 2024	☛6.1-7	03 OCT 2024	2.1-1	05 SEP 2024
4.2-2	01 APR 2005	6.2-1	01 DEC 2008	2.1-2	01 AUG 2015
4.2-3	30 NOV 2023	☛6.2-2	03 OCT 2024	2.1-3	18 JUL 2019

<i>Page</i>	<i>Date</i>	<i>Page</i>	<i>Date</i>	<i>Page</i>	<i>Date</i>
2.1-4	11 JUL 2024	2.4-9	01 AUG 2007	2.5-40	06 OCT 2022
2.1-5	20 MAY 2021	2.4-10	01 DEC 2001	2.5-41	18 APR 2024
2.1-6	18 JUL 2019	2.4-11	21 MAR 2024	2.5-42	06 OCT 2022
2.1-7	05 SEP 2024	☛2.4-13	20 FEB 2025	2.5-43	11 JUL 2024
2.1-8	01 DEC 2013	☛2.4-15	20 FEB 2025	2.6-1	03 OCT 2024
2.1-9	01 DEC 2013	2.4-17	21 MAR 2024	2.6-2	03 OCT 2024
2.1-10	28 MAY 2015	2.4-19	21 MAR 2024	2.6-3	03 OCT 2024
2.1-11	20 MAY 2021	2.4-21	21 MAR 2024	2.6-4	03 OCT 2024
2.1-13	28 MAY 2015	2.4-23	21 MAR 2024	2.6-5	03 OCT 2024
2.1-15	01 APR 2017	2.4-25	21 MAR 2024	2.6-6	03 OCT 2024
2.2-1	07 SEP 2023	2.5-1	21 APR 2022	2.6-7	03 OCT 2024
2.2-2	07 SEP 2023	2.5-2	21 APR 2022	2.6-8	05 OCT 2023
2.2-3	07 SEP 2023	2.5-3	21 MAR 2024	2.6-9	03 OCT 2024
2.2-4	07 SEP 2023	2.5-4	21 APR 2022	2.6-10	03 OCT 2024
2.2-5	07 SEP 2023	2.5-5	21 APR 2022	2.6-11	03 OCT 2024
2.2-6	07 SEP 2023	2.5-6	21 APR 2022	2.6-12	03 OCT 2024
2.2-7	18 JUL 2019	2.5-7	22 FEB 2024	2.6-13	03 OCT 2024
2.2-8	30 NOV 2023	2.5-8	21 APR 2022	2.6-15	03 OCT 2024
2.2-9	07 SEP 2023	2.5-9	21 MAR 2024	2.7-1	20 MAY 2021
2.2-10	07 SEP 2023	2.5-10	01 DEC 2022	2.7-2	01 JUN 1997
2.2-11	07 SEP 2023	2.5-11	05 SEP 2024	2.7-3	01 JUN 1997
2.2-13	07 SEP 2023	2.5-12	30 NOV 2023	2.7-4	01 AUG 2010
2.2-15	30 NOV 2023	2.5-13	21 APR 2022	2.7-5	20 MAY 2021
2.2-17	07 SEP 2023	2.5-14	06 OCT 2022	2.7-6	01 DEC 2004
2.2-19	30 NOV 2023	2.5-15	21 MAR 2024	2.7-7	01 JUN 1997
2.3-1	27 JAN 2022	2.5-16	21 APR 2022	2.7-8	01 JUN 1997
2.3-2	27 JAN 2022	2.5-17	21 MAR 2024	2.7-9	01 JUN 1997
2.3-3	05 DEC 2019	2.5-18	21 APR 2022	2.7-11	20 MAY 2021
2.3-4	01 DEC 2013	2.5-19	01 DEC 2022	2.8-1	20 MAY 2021
2.3-5	20 MAY 2021	2.5-21	01 DEC 2022	2.8-2	01 AUG 2014
2.3-6	02 JAN 2017	2.5-23	14 JUL 2022	2.8-3	05 NOV 1998
2.3-7	05 NOV 2020	2.5-25	14 JUL 2022	2.8-4	10 DEC 2015
2.3-8	05 DEC 2019	2.5-27	18 APR 2024	2.8-5	20 MAY 2021
2.3-9	23 MAY 2019	2.5-28	06 OCT 2022	2.8-6	01 APR 2013
2.3-10	23 MAY 2019	2.5-29	18 APR 2024	2.8-7	05 NOV 2020
2.3-11	20 MAY 2021	2.5-30	06 OCT 2022	2.8-8	30 NOV 2023
2.3-13	10 DEC 2015	2.5-31	18 APR 2024	2.8-9	30 NOV 2023
2.3-15	10 DEC 2015	2.5-32	06 OCT 2022	2.8-10	30 NOV 2023
☛2.4-1	20 FEB 2025	2.5-33	18 APR 2024	2.8-11	20 MAY 2021
☛2.4-2	20 FEB 2025	2.5-34	06 OCT 2022	2.8-13	20 MAY 2021
☛2.4-3	20 FEB 2025	2.5-35	18 APR 2024	2.8-15	20 MAY 2021
2.4-4	01 DEC 2007	2.5-36	06 OCT 2022	2.8-17	06 OCT 2022
2.4-5	20 MAY 2021	2.5-37	18 APR 2024	2.8-18	06 OCT 2022
2.4-6	02 JAN 2017	2.5-38	06 OCT 2022	2.8-19	06 OCT 2022
2.4-7	05 NOV 2020	2.5-39	18 APR 2024	2.8-20	06 OCT 2022
2.4-8	13 JUN 2024				

5. List of aeronautical charts available

Those chart series marked by an asterisk (*) form part of the AIP:

<i>Title of Series</i>	<i>Scale</i>	<i>Name and/or number</i>	<i>Price (\$)</i>	<i>Date</i>
Aerodrome/Heliport Chart – ICAO (AC)*	1:10 000	Artigas		20 MAY 21
		Carmelo		30 NOV 23
		Colonia/Laguna de los Patos		20 MAY 21
		Durazno/Santa Bernardina		
		03-21		☛20 FEB 25
		10-28		☛20 FEB 25
		Maldonado/Carlos A. Curbelo		
		Laguna del Sauce		
		01-19		21 MAR 24
		08-26		21 MAR 24
		Melo/Cerro Largo		03 OCT 24
		Mercedes/Ricardo Detomasi		20 MAY 21
		Montevideo/Ángel S. Adami		20 MAY 21
		Montevideo/Carrasco Cesáreo		
		L. Berisso		
		01-19		03 OCT 24
		07-25		03 OCT 24
		Paysandú/Tydeo Larre Borges		28 NOV 24
		Punta del Este/El Jagüel		27 JAN 22
		Río Branco		20 MAY 21
Rivera/Oscar D. Gestido		05 SEP 24		
Salto/Nueva Hespérides		03 OCT 24		
Tacuarembó		05 OCT 23		
Treinta y Tres		12 AUG 21		
Vichadero		20 MAY 21		
Aerodrome Ground Movement Chart - ICAO (AGMC)*		Montevideo/Ángel S. Adami		20 MAY 21
		Montevideo/Carrasco Cesáreo L. Berisso		03 OCT 24
Aircraft Parking/Docking Chart - ICAO (APC)*		Maldonado/Carlos A. Curbelo		
		Laguna del Sauce		
		(Aviación Comercial)		01 DEC 22
		(Aviación General)		01 DEC 22
		Montevideo/Ángel S. Adami		20 MAY 21
Montevideo/Carrasco Cesáreo L. Berisso		06 OCT 22		
Aerodrome Obstacle Chart - ICAO Type A (AOC)*		Maldonado/Carlos A. Curbelo		
		Laguna del Sauce		
		01-19		14 JUL 22
		08-26		14 JUL 22
		Montevideo/Carrasco Cesáreo L. Berisso		
		01-19		12 AUG 21
07-25		06 OCT 22		

<i>Title of Series</i>	<i>Scale</i>	<i>Name and/or number</i>	<i>Price (\$)</i>	<i>Date</i>
Aerodrome Obstacle Chart - ICAO Type A (AOC)*		Carmelo		07 SEP 23
		Melo/Cerro Largo		03 OCT 24
		☛ Paysandú/Tydeo Larre Borges		☛ 28 NOV 24
		Rivera/Oscar D. Gestido		05 SEP 24
		Salto/Nueva Hespérides		25 JAN 24
En-route Chart - ICAO (EC)*	1:2 000 000	EC Conventional Navigation International Routes		03 OCT 24
		EC Area Navigation Routes		03 OCT 24
		EC Conventional Navigation National Routes		03 OCT 24
Area Chart - ICAO*		TMA Carrasco - Conventional Navigation International and National Routes		18 APR 24
		TMA Carrasco - Area Navigation Routes		18 APR 24
		TMA Durazno - Conventional Navigation International and National Routes		21 MAR 24
		TMA Durazno - Area Navigation Routes		03 OCT 24
Standard Departure Chart - Instrument (SID) - ICAO*	1:600 000	Maldonado/Carlos A. Curbelo Laguna del Sauce		Nil
		Carrasco		Nil
Standard Arrival Chart - Instrument (STAR) - ICAO*	1:600 000	Maldonado/Carlos A. Curbelo Laguna del Sauce		Nil
		Montevideo/Carrasco Cesáreo L. Berisso		Nil
Instrument Approach Chart - ICAO (IAC)*	1:300 000	Artigas		28 MAY 15
		RNAV (GNSS) 11		
		Colonia/Laguna de los Patos		
		RNAV (GNSS) 13		10 DEC 15
		RNAV (GNSS) 31		10 DEC 15
		Durazno/Santa Bernardina		
		DME VOR 03		21 MAR 24
		RNAV (GNSS) 10		21 MAR 24
		RNAV (GNSS) 21		21 MAR 24
		HI VOR/DME 03		21 MAR 24
VOR DME 03		21 MAR 24		

7. ATS units address list

<i>Unit name</i>	<i>Postal address</i>	<i>Telephone NR</i>	<i>Telefax NR</i>	<i>Telex NR</i>	<i>AFS address</i>
1	2	3	4	5	6
Artigas TWR	Aeropuerto Intl de Artigas Artigas	4772 3971	4772 3971		SUAGZTX
Colonia TWR	Aeropuerto Intl de Colonia Colonia	4522 4853	4522 2319		SUCAZTX
Parallada TWR/APP	Santa Bernardina Aerop. Intl de Alternativa Durazno	4362 2182	4362 4927		SUDUZTX
Curbelo TWR	Aeropuerto Intl C/C Carlos A. Curbelo "Laguna del Sauce" Ruta 93 Km 113 Maldonado	4255 9777 ☎ ext. 125	☎ 4255 9904 ☎ ☎		SULSZTX
Melo TWR	Aeropuerto Intl de Cerro Largo Melo	4640 2422	4640 2027		SUMOZTX
Adami TWR	Aeropuerto Ángel S. Adami Melilla, Montevideo	2322 8035/ 43	2322 8035		SUAAZTX
Carrasco APP	Aeropuerto Intl de Carrasco "Gral. Cesáreo L. Berisso" 14000 Canelones	2600 0619 2604 0408 ext. 5119			SUMUZAZX
Montevideo ACC	Ídem Carrasco APP	2600 0619 2604 0408 ext. 5119			SUEOZQZX
Carrasco TWR	Ídem Carrasco APP	2604 0408 ext. 5250	2604 0298		SUMUZTX
Paysandú AFIS	Aeropuerto Intl Paysandú Paysandú	4722 2079	4722 2199		SUPUZTX
Punta del Este TWR	Aeropuerto Dptal Punta del Este "El Jagüel". Maldonado	4248 1808	4248 4513		SUPEZTX
Rivera TWR	Aeropuerto Intl de Rivera Presidente General Oscar D. Gestido. Rivera	4620 2121	4620 2121		SURVZTX
Salto TWR	Aeropuerto Intl de Salto Salto	4732 7119	4732 7119		SUSOZTX
Tacuarembó AFIS	Aeropuerto Dptal Tacuarembó Tacuarembó	4632 3938	4632 3938		SUTBZTX

**INTENTIONALLY
LEFT BLANK**

GEN 3.7 SERVICE OF INSPECTORS OF COMMERCIAL AIR TRANSPORT

1. Responsible service

The service of inspectors of Commercial Air Transport which is part of the Dirección General de Aviación Civil (General Direction of Civil Aviation) of Uruguay is that which in representation of the General Director of Civil Aviation has as its duties to supervise the compliance of the regulations and norms concerning the operation of civil aircraft, air crews and land staff.

By decree of the Poder Ejecutivo NR 18.365 of May 15, 1951 these duties were assigned to the inspectors of air traffic of the Dirección General de Aviación Civil (General Direction of Civil Aviation) and also those conferred by the Decree 319/96 of Aug 13, 1996.

Dirección General de Aviación Civil
División Inspectoría
Aeropuerto Intl. de Carrasco "Gral. Cesáreo L. Berisso"
Avda. de las Industrias Wilson Ferreira Aldunate N° 5519 (ex Cno. Carrasco)
C.P. 14002 Canelones - URUGUAY
Tel.: 2604 0408 extension 4062
e-mail: tac@dinacia.gub.uy

Dirección General de Aviación Civil
Departamento de Inspectores AIC
Aeropuerto Intl de Carrasco "Gral. Cesáreo L. Berisso"
14000 Canelones - URUGUAY
Tel.: 2604 0329 Interno 1/1364 (H24) and Cellular phone 098 373138
Telefax: 2604 0290

Dirección General de Aviación Civil
Departamento de Inspectores TAC
Aeropuerto Ángel S. Adami
C.P. 12900 Montevideo URUGUAY
Tel.: 2322 8035 extension 209

Dirección General de Aviación Civil
Inspectores TAC
Aeropuerto C/C Carlos A. Curbelo - Laguna del Sauce
C.P. 20100 Maldonado URUGUAY
☎Tel.: 4255 9777 extension 157 and Telefax 4255 9007

2. Area of responsibility

The service of inspectors of Air Commercial Transport has the faculty to adopt the necessary measures to ensure the compliance of the standing aerocommercial regulations trying to avoid the damages either from the action or the omission of the aeronautical service users and providers.

To authorize the requests from the providers and operators of aeronautical services for landing, overflights, change of aircraft, charter, ferry, and ambulance flights in coordination with the rest of the departments in charge of the operations. They will also exercise permanent control over the formalities of the airlines (article 209 Aeronautical code, article 21 literal A of Decree 325/974 of Apr 26, 1974). To receive the documentation of airlines according to Decree 611/978 articles 1, 2 and 3 (GEN 1.2-3).

Give the necessary support and attention to the airline user in accordance with the standing and recommended regulations. Receive reports, complaints, and any other written documents the passenger may wish to file as well as any detection of operational irregularities made sua sponte.

Supervision and monitoring of routes, timetables and flight cancellations as well as the custody of the traffic Rights. To

- adopt the necessary measures in case of flight incident or accident reporting such facts to the competent
- authorities and to the Aviation Incident and Accident Investigation Commission (CIAIA).

AD 2. AERODROMES**SUDU AD 2.4-1 AERODROME LOCATION INDICATOR AND NAME**

SUDU - DURAZNO/Santa Bernardina Intl of Alternative

SUDU 2.4-2 AERODROME GEOGRAPHICAL AND ADMINISTRATIVE DATA

1	<i>ARP coordinates and site at AD</i>	332123S 0562946W DUR VOR/DME location
2	<i>Direction and distance from (city)</i>	3 KM E from Durazno city
3	<i>Elevation/Reference temperature</i>	93 M (305 FT) / 32°C
4	<i>Geoid undulation at AD ELEV PSN</i>	17 M
5	<i>MAG VAR/Annual change</i>	12° W (JAN 2020) / 0.15° increasing
6	<i>AD operator, address, telephone, telefax, e-mail address, AFS address, website address</i>	<p>✈ Puerta del Sur S.A. Aeropuerto Intl de Alternativa Santa Bernardina Durazno Tel: 4362 2182, 4362 2449 Telefax: 4362 4927 ✈ Puerta del Sur S.A.Operations: 092075236 e-mail: sudu@dinacia.gub.uy AFS: SUDUYTYX</p>
7	<i>Types of traffic permitted (IFR/VFR)</i>	IFR/VFR
8	<i>Remarks</i>	Nil

SUDU AD 2.4-3 OPERATIONAL HOURS

1	<i>AD Operator</i>	✈ H24
2	<i>Customs and immigration</i>	O/R
3	<i>Health and sanitation</i>	First aids and ambulance
4	<i>AIS Briefing Office</i>	Nil
5	<i>ATS Reporting Office (ARO)</i>	✈ MON - FRI 11:00 to 17:00 UTC. HOL and others: O/R previous coordination 24 HR in advance with Base OPS Centre (MON - FRI 11:00 to 17:00 UTC TEL (598)43622182)
6	<i>MET Briefing Office</i>	✈ As ATS Reporting Office (ARO)
7	<i>ATS</i>	✈ As ATS Reporting Office (ARO)
8	<i>Fuelling</i>	✈ As ATS Reporting Office (ARO)
9	<i>Handling</i>	✈ As ATS Reporting Office (ARO)
10	<i>Security</i>	✈ As ATS Reporting Office (ARO)
11	<i>De-icing</i>	Nil
12	<i>Remarks</i>	Nil

SUDU AD 2.4-4 HANDLING SERVICES AND FACILITIES

1	<i>Cargo-handling facilities</i>	Nil
2	<i>Fuel/oil types</i>	☛ 100/130, JET-A1, AVGAS in Commercial Apron
3	<i>Fuelling facilities/capacity</i>	☛ 100/130: 18 000 L, JET-A1: 30 000 L, AVGAS: 5 000 L
4	<i>De-icing facilities</i>	Nil
5	<i>Hangar space for visiting aircraft</i>	Nil
6	<i>Repair facilities for visiting aircraft</i>	Nil
7	<i>Remarks</i>	Nil

SUDU AD 2.4-5 PASSENGER FACILITIES

1	<i>Hotels</i>	In the city
2	<i>Restaurants</i>	In the city
3	<i>Transportation</i>	Taxis O/R; DLY bus service from 09:00 to 21:00 UTC
4	<i>Medical facilities</i>	First aids and ambulance
5	<i>Bank and Post Office</i>	Nil
6	<i>Tourist Office</i>	Nil
7	<i>Remarks</i>	Nil

SUDU AD 2.4-6 RESCUE AND FIRE FIGHTING SERVICES

1	<i>AD category for fire fighting</i>	☛ CAT 07
2	<i>Rescue equipment</i>	Tools and approach equipment
3	<i>Capability for removal of disabled aircraft</i>	Nil
4	<i>Remarks</i>	In case of major accident, FAU aircraft support immediate response, FAU rescue personnel, firefighters and doctors specializing in severe polytrauma.

SUDU AD 2.4-7 SEASONAL AVAILABILITY - CLEARING

1	<i>Types of clearing equipment</i>	Nil
---	------------------------------------	-----

SUDU AD 2.4-8 APRONS, TAXIWAYS AND CHECK LOCATIONS/POSITIONS DATA

1	<i>Apron surface and strength</i>	Surface: asphalt concrete - concrete Strength: 21/F/B/W/U <ul style="list-style-type: none"> ☛ Commercial Apron: <ul style="list-style-type: none"> ☛ Surface: asphalt concrete ☛ Strength: 12/F/B/Y/U
2	<i>Taxiway width, surface and strength</i>	<ul style="list-style-type: none"> ☛ Width: Taxiways "A", "B", "C" and "D" 23 M; "E" 10.5 M Surface: asphalt concrete ☛ Strength: Taxiways "A", "B" and "C" limited to 20 tons; "E" 12/F/B/Y/U
3	<i>Altimeter checkpoint location and elevation</i>	Superior apron (332129S/0563030W) 82 M
4	<i>VOR checkpoints</i>	Nil
5	<i>INS checkpoints</i>	Nil
6	<i>Remarks</i>	Nil

SUDU AD 2.4-9 SURFACE MOVEMENT GUIDANCE AND CONTROL SYSTEM AND MARKINGS

1	<i>Use of aircraft stand ID signs, TWY guide lines and visual docking/parking guidance system of aircraft stands</i>	<ul style="list-style-type: none"> ☛ Commercial Apron: aircraft stands identification signs. ☛ TWY "E": centre line signs. ☛ Visual docking guidance system: Nil
2	<i>RWY and TWY markings and LGT</i>	<ul style="list-style-type: none"> ☛ RWY: <u>Markings</u>: designation, centre line, THR and runway side stripe marking, 10/28 holding position (65 M of 03/21 centre line) ☛ TWY: <u>Markings</u>: designation of centre line <u>LGT</u>: TWY edge lights in TWY "E".
3	<i>Stop bars</i>	Nil
4	<i>Remarks</i>	Nil

SUDU AD 2.4-10 AERODROME OBSTACLES

<i>In approach/TKOF areas</i>				<i>In circling area and at AD</i>			<i>Remarks</i>
1				2			3
<i>RWY/Area affected</i>	<i>Obstacle type</i>	<i>Elevation</i>	<i>Coordinates</i>	<i>Obstacle type</i>	<i>Elevation</i>	<i>Coordinates</i>	Nil
<i>Markings/LGT</i>			<i>Markings/LGT</i>				
a	b	c	a	b			
21/APCH	Trees 30 M		No data AVBL	Trees 20 M		No data AVBL	

SUDU AD 2.4-11 METEOROLOGICAL INFORMATION PROVIDED

1	<i>Associated MET Office</i>	DURAZNO
2	<i>Hours of service</i> <i>MET Office outside hours</i>	H 24
3	<i>Office responsible for TAF preparation</i> <i>Periods of validity</i>	Surveillance MET Office CARRASCO: O/R H 24
4	<i>Trend forecast</i> <i>Interval of issuance</i>	TREND O/R
5	<i>Briefing/consultation provided</i>	Personal inquiries
6	<i>Flight documentation</i> <i>Language(s) used</i>	Nil
7	<i>Charts and other information available</i> <i>for briefing or consultation</i>	S, U, P, T
8	<i>Supplementary equipment available for providing information</i>	Telefax
9	<i>ATS units provided with information</i>	DURAZNO TWR, OPS
10	<i>Additional information (limitation of service, etc.)</i>	Nil

AERODROME/HELIPORT CHART - ICAO	33°21'23"S 056°29'46"W	ELEV 93 (305)	TWR 126.2 APRON 000.0	DURAZNO/Intl Altn Santa Bernardina
------------------------------------	---	--------------------------------	--	---

RWY	DIRECTION	THR	GUND	BEARING STRENGTH
03	035°	33°22'09.82"S 56°30'16.63"W	16.6 M	Runway and Apron PCN 21/F/B/W/T
21	215°	33°21'01.81"S 56°29'41.76"W	16.6 M	
10	099°	33°21'34.45"S 56°30'39.00"W	16.6 M	Taxiways "A", "B" and "C" limited to 20 tons.
28	279°	33°21'31.67"S 56°29'42.92"W	16.6 M	Taxiway "E" PCN 12/F/B/Y/U.

TAXIWAYS "A", "B" and "C" 23 WIDE; "E" 10.5 WIDE

ELEVATIONS IN METRES (AND FEET)
DIMENSIONS IN METRES
BEARINGS ARE MAGNETIC

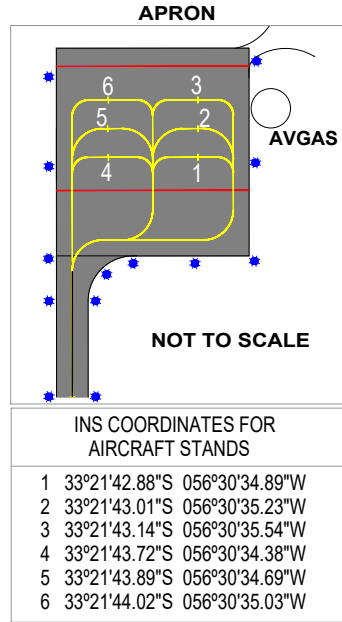
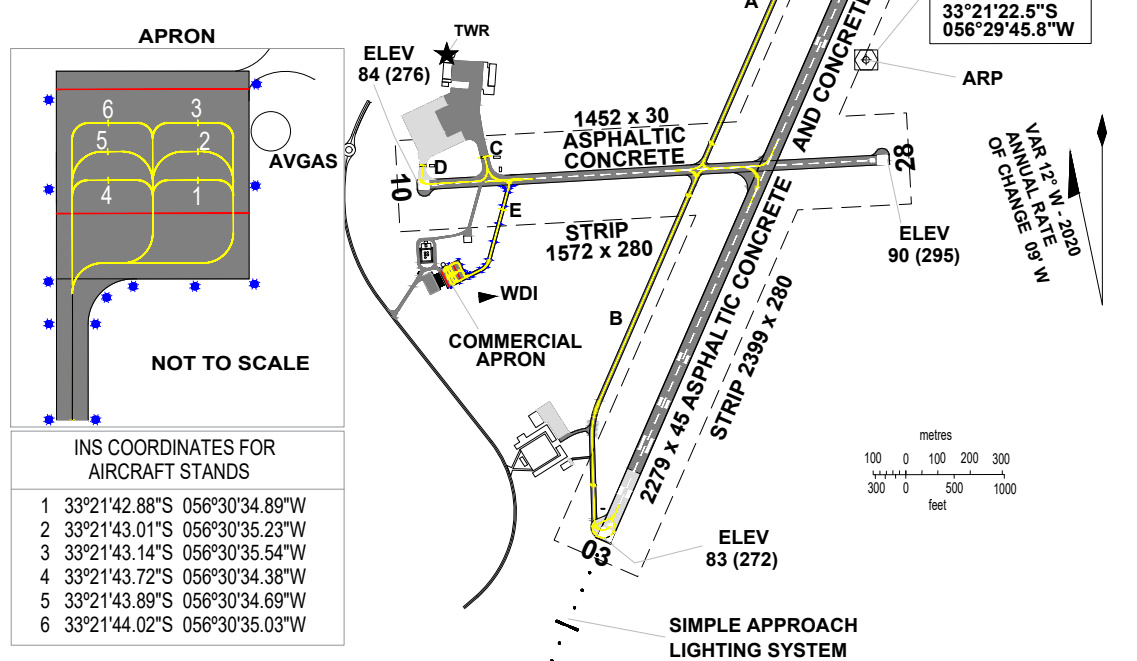

MARKING AIDS RWY 03/21 AND EXIT TWY

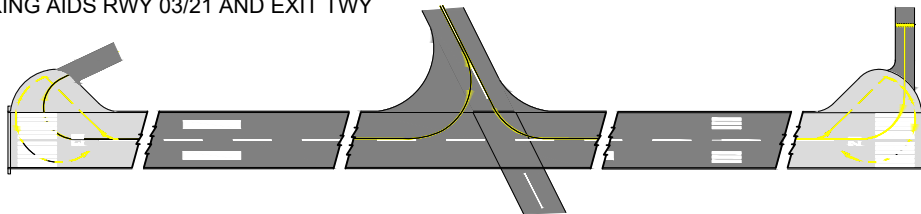

LIGHTING AIDS RWY 03/21 AND EXIT TWY

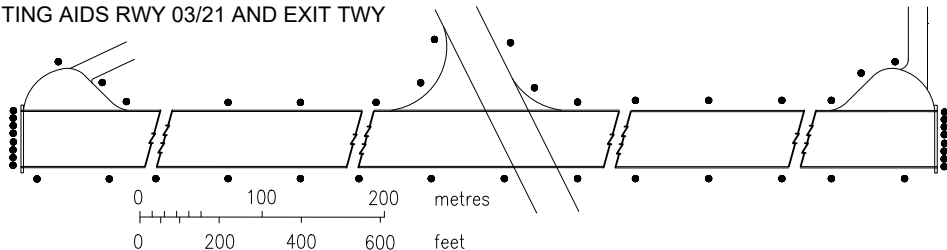

**INTENTIONALLY
LEFT BLANK**

AERODROME/HELIPORT
CHART - ICAO

33°21'23"S ELEV 93
056°29'46"W (305)

TWR 126.2
APRON 000.0

DURAZNO/Intl Altn
Santa Bernardina

RWY	DIRECTION	THR	GUND	BEARING STRENGTH
03	035°	33°22'09.82"S 56°30'16.63"W	16.6 M	Runway and Apron PCN 21/F/B/W/T
21	215°	33°21'01.81"S 56°29'41.76"W	16.6 M	
10	099°	33°21'34.45"S 56°30'39.00"W	16.6 M	Taxiways "A", "B" and "C" limited to 20 tons.
28	279°	33°21'31.67"S 56°29'42.92"W	16.6 M	Taxiway "E" PCN 12/F/B/Y/U.

TAXIWAYS "A", "B" and "C" 23 WIDE; "E" 10.5 WIDE

ELEVATIONS IN METRES (AND FEET)
DIMENSIONS IN METRES
BEARINGS ARE MAGNETIC

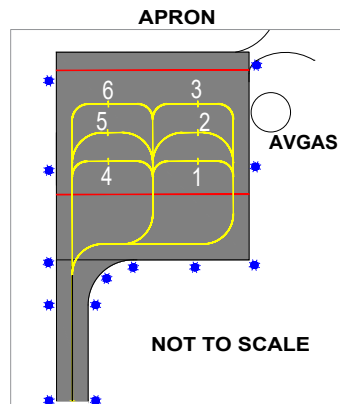

INS COORDINATES FOR
AIRCRAFT STANDS

- 1 33°21'42.88"S 056°30'34.89"W
- 2 33°21'43.01"S 056°30'35.23"W
- 3 33°21'43.14"S 056°30'35.54"W
- 4 33°21'43.72"S 056°30'34.38"W
- 5 33°21'43.89"S 056°30'34.69"W
- 6 33°21'44.02"S 056°30'35.03"W

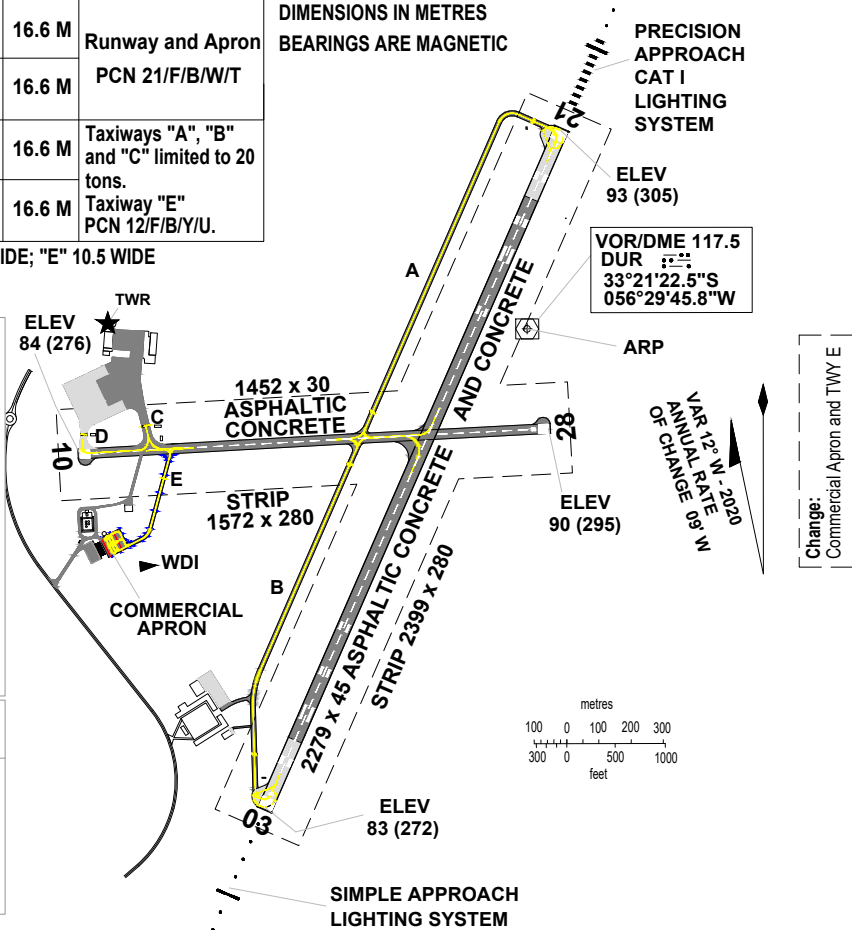

MARKING AIDS RWY 10/28 AND EXIT TWY

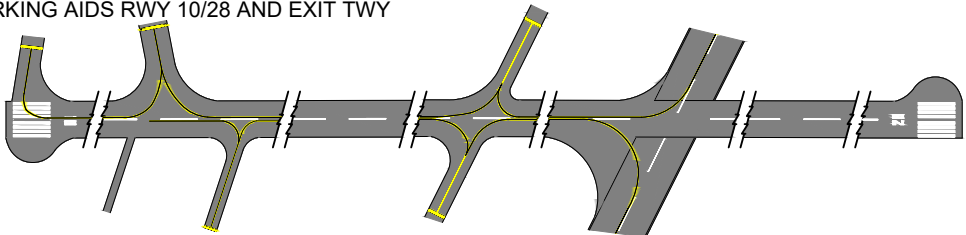

LIGHTING AIDS RWY 10/28 AND EXIT TWY

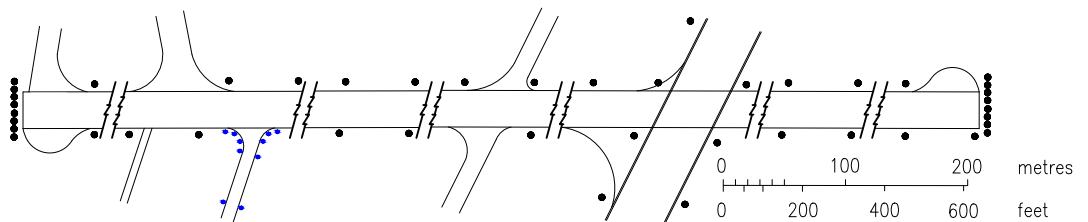

**INTENTIONALLY
LEFT BLANK**